

7.1.4.5) WATER DISTRIBUTION SYSTEM IN THE CAMPUS

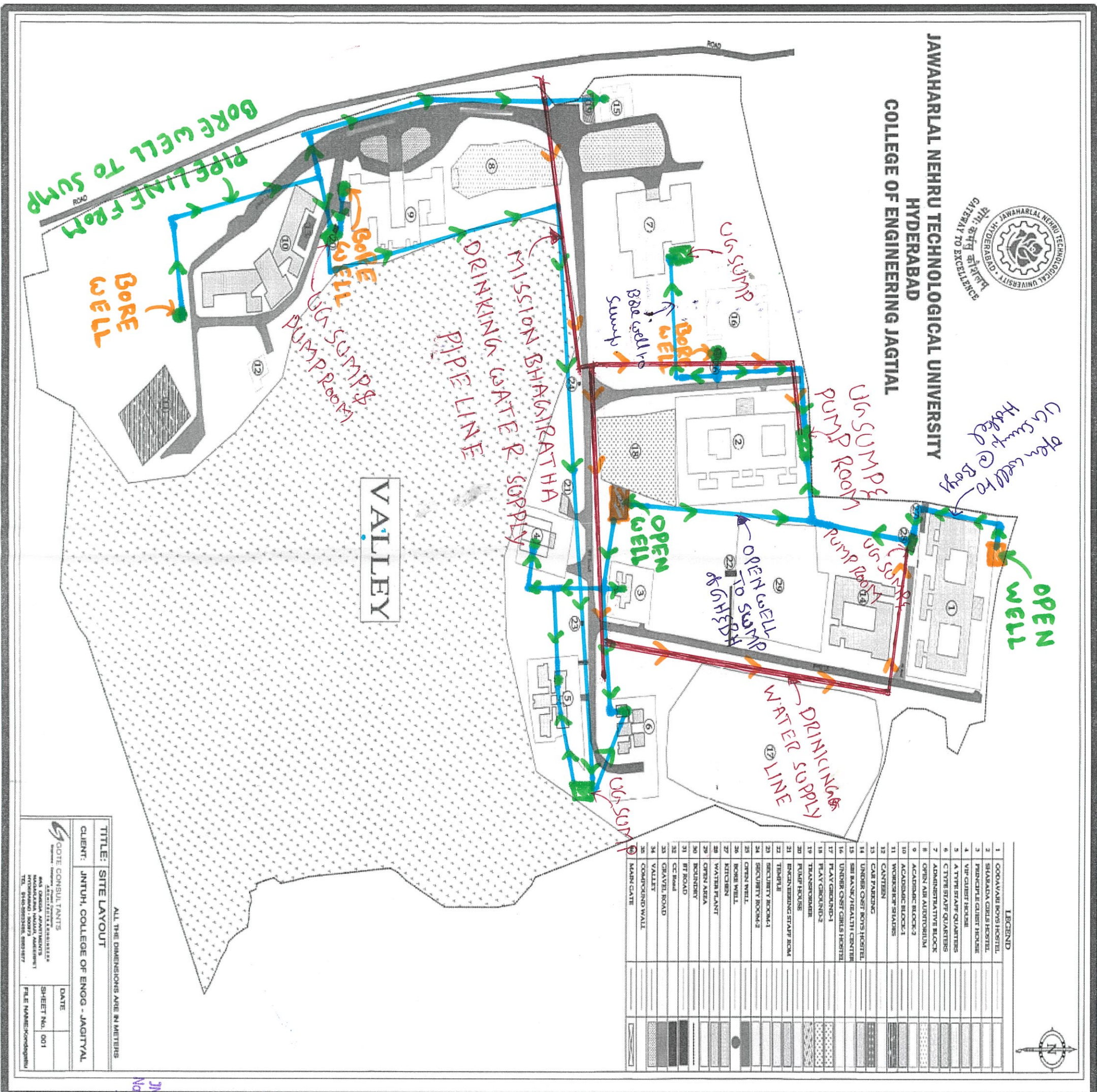

JAWAHARLAL NEHRU TECHNOLOGICAL UNIVERSITY
HYDERABAD
COLLEGE OF ENGINEERING JAGTIAL

OPEN WELL
UG Sump @ Boys
Hacked

PIPELINE FROM
BORE WELL TO SUMP

BORE WELL

UG Sump & Pump Room

VALLEY

MISSION BHAKIRATHA
DRINKING WATER SUPPLY
PIPELINE

OPEN WELL
UG Sump & Pump Room

DRINKING WATER SUPPLY LINE

TITLE: SITE LAYOUT
CLIENT: JNTUH, COLLEGE OF ENOG - JAGTIAL

ALL THE DIMENSIONS ARE IN METERS

GOTE CONSULTANTS
AND OTHERS
SHEET NO. 001
FILE NAME: Kondagathu

PRINCIPAL
JNTUH College of Engineering Jagtial
Nandipally (Kondagathu), Kodimiri(M)
Jagtial (Dist)-505 501, Telangana.

7.1.4.5) WATER DISTRIBUTION SYSTEM FOR ACADEMIC BLOCK - I

ACADEMIC BLOCK - SECOND FLOOR

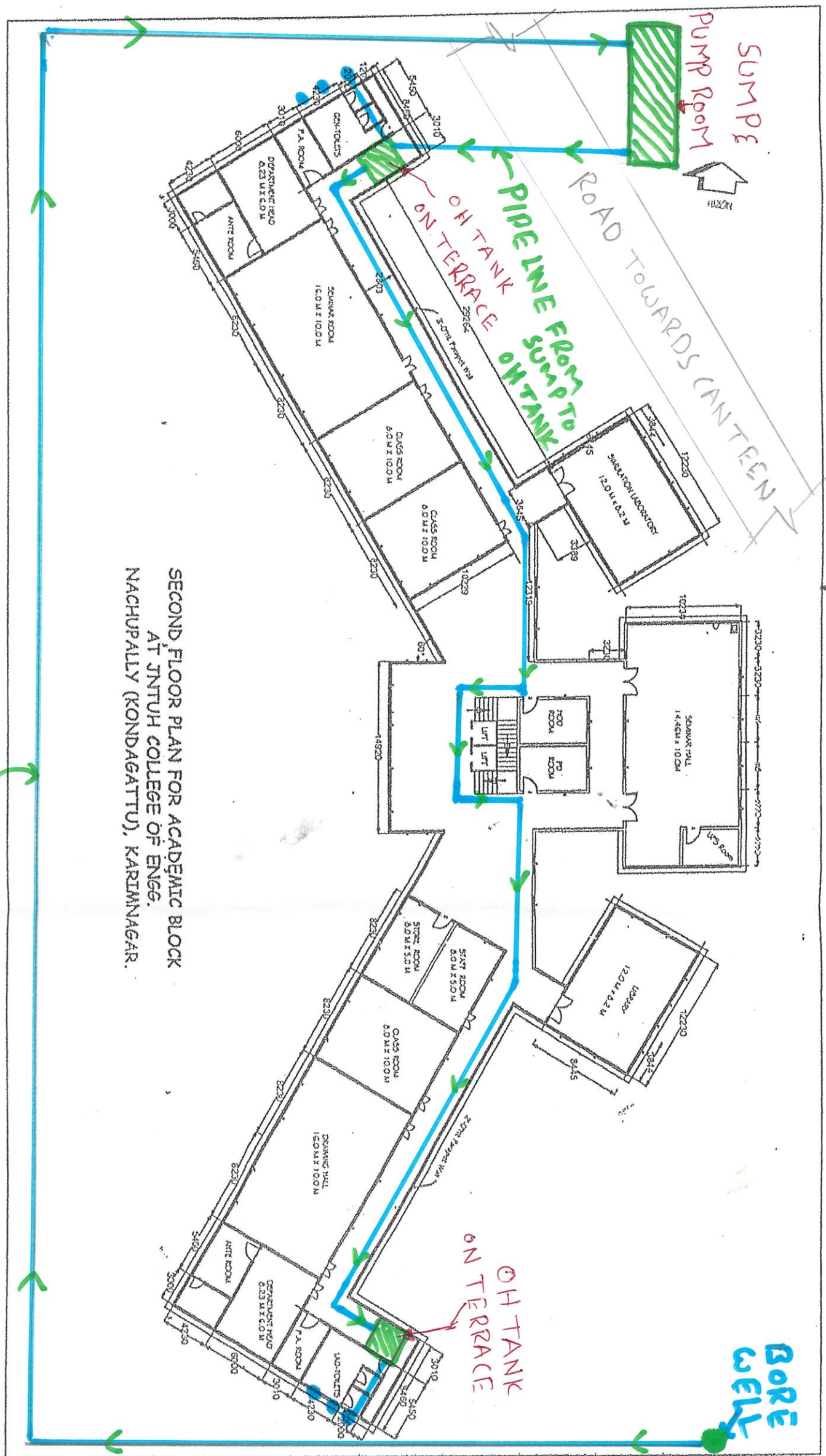

PIPE LINE FROM BORE WELL TO SUMP

SECOND FLOOR PLAN FOR ACADEMIC BLOCK AT JNTUH COLLEGE OF ENGG. NACHUPALLY (KONDAGATTU), KARIMNAGAR.

[Handwritten Signature]

PLAN SHOWING ACADEMIC BLOCK IN CAMPUS OF JNTUH COLLEGE OF ENGINEERING, NACHUPALLY (KONDAGATTU) IN SY.Nos: 231, 193 & 171 SITUATED AT NACHUPALLY VILLAGE, KODIMAL MANDAL, KARIMNAGAR (Dist), AP.

BELONGS TO : JNTUH COLLEGE OF ENGINEERING NACHUPALLY

SPECIFICATION:

- FOUNDATION : R.C.C FOOTING OVER R.C.C BED
- BASEMENT : C.C.S MASONRY IN CM
- SUPERSTRUCTURE : BRICK MASONRY IN CM
- UNITED, CHAIRS & COLUMNS : R.C.C
- SLABS & BEAMS : R.C.C
- PLASTERING : IN CM
- FLOORING : MARBLE/GRANITE TILES
- DOORS : AL FRAMED GLAZED & DOORS
- WINDOWS & VENTILATORS : POWDER COATED AL FRAMED GLAZ
- RAILING : S.S RAILING

AREA (In Sqm)

LOWER GROUND FLOOR	: 2286
FIRST FLOOR	: 2196
SECOND FLOOR	: 2196
TOTAL	: 7278

REFERENCE:

- PROPOSED
- EXISTING

BUREAU OF INDUSTRIAL CONSULTANCY SERVICE



JAWAHARLAL NEHRU TECHNOLOGICAL UNIVERSITY KUKATPALLY, HYDERABAD - 500 072.

SIGNATURE OF APPROVING AUTHORITY

PRINCIPAL
JNTUH College of Engineering Jagtior Nachupally (Kondagattu), Kodimal(M) Jagtior (Dist) 505 501, Telangana.